

WATERBURY

FEGC F 013-4(13)

SENATE TRANSPORTATION COMMITTEE, MARCH 26, 2021

KEN UPMAL, PROJECT MANAGER, VERMONT AGENCY OF TRANSPORTATION

CASEY LEACH, PROJECT ENGINEER, VERMONT AGENCY OF TRANSPORTATION



WATERBURY MAIN STREET



Combined networks of communication and electrical conduits were placed throughout roughly $\frac{3}{4}$ of the project for underground utilities.





Long runs of conduit for under electric and communication lines being installed under driveways and through parking areas.



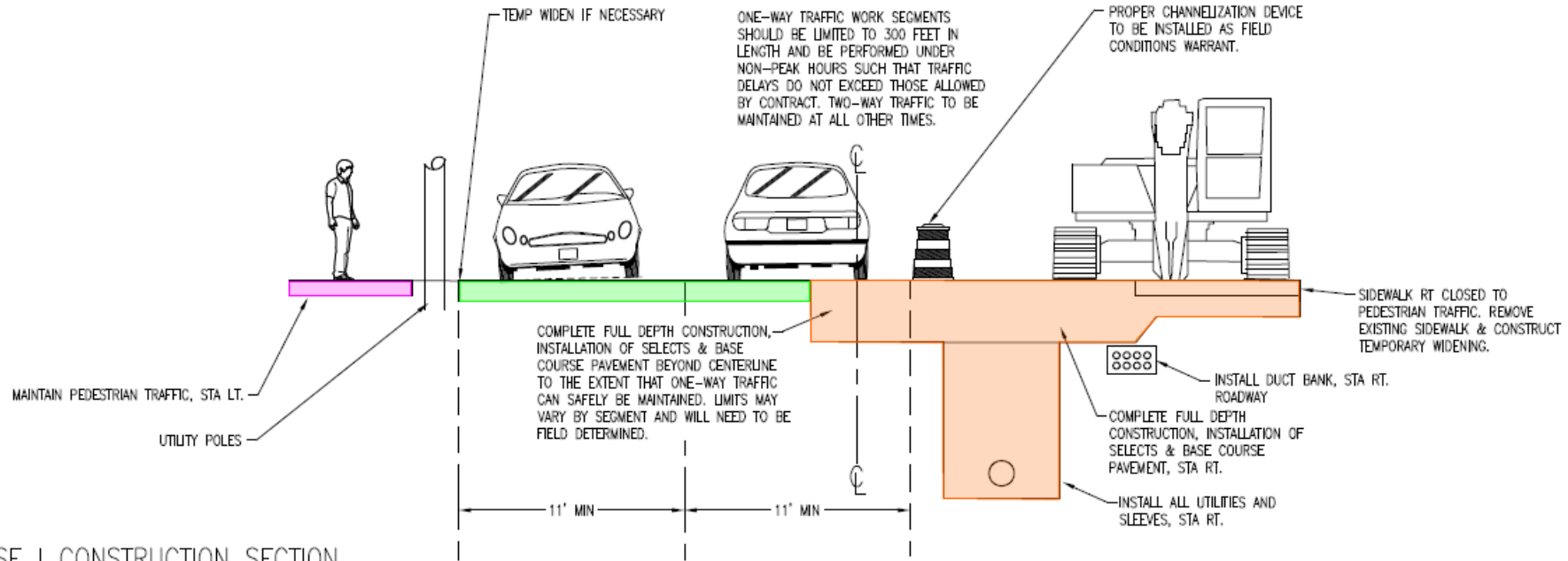

PHASE I CONSTRUCTION SECTION

SCALE: N.T.S.

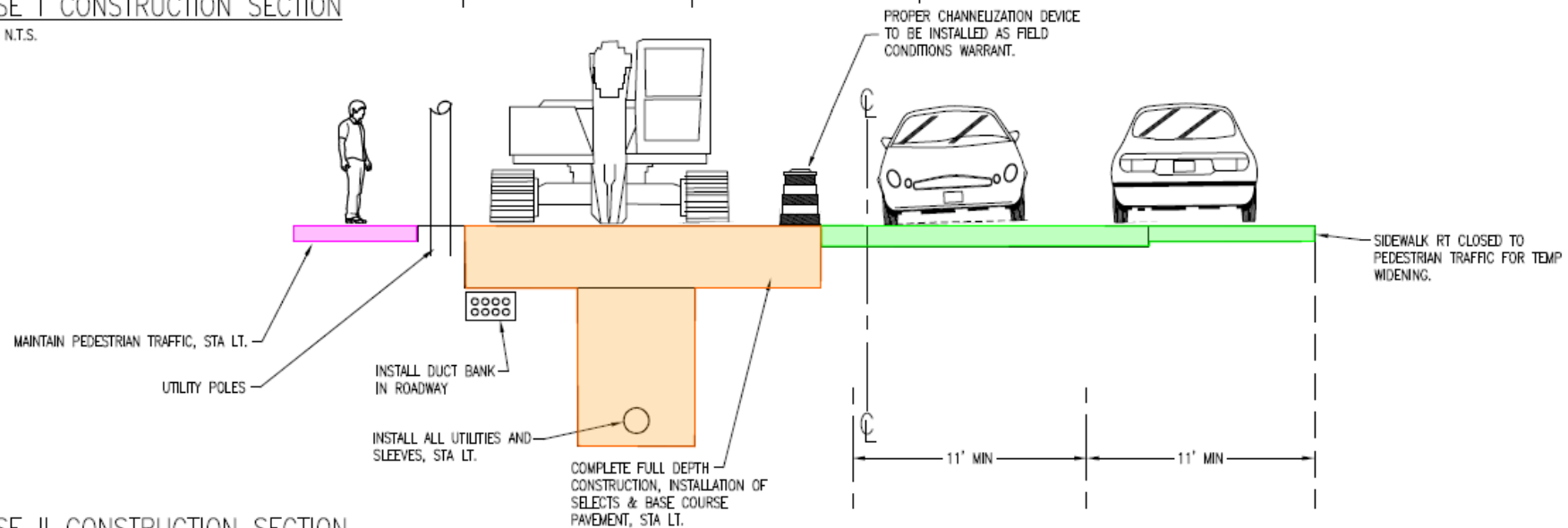

PHASE II CONSTRUCTION SECTION

SCALE: N.T.S.



Alternating one-way traffic used for deep utility installation.







Heavy work was required close to buildings. Pedestrian flaggers assisted people in and out as needed.

Vibration monitoring equipment was used to make sure levels were not dangerous to buildings.





Temporary measures implemented for residents and pedestrians to have access to residences and businesses.





Temporary measures implemented for residents and pedestrians to have access to residences and businesses.





Rerouting existing utilities was not an option. Temporary supports had to be used to make sure they stayed secure while working around the poles.



Sand Filter

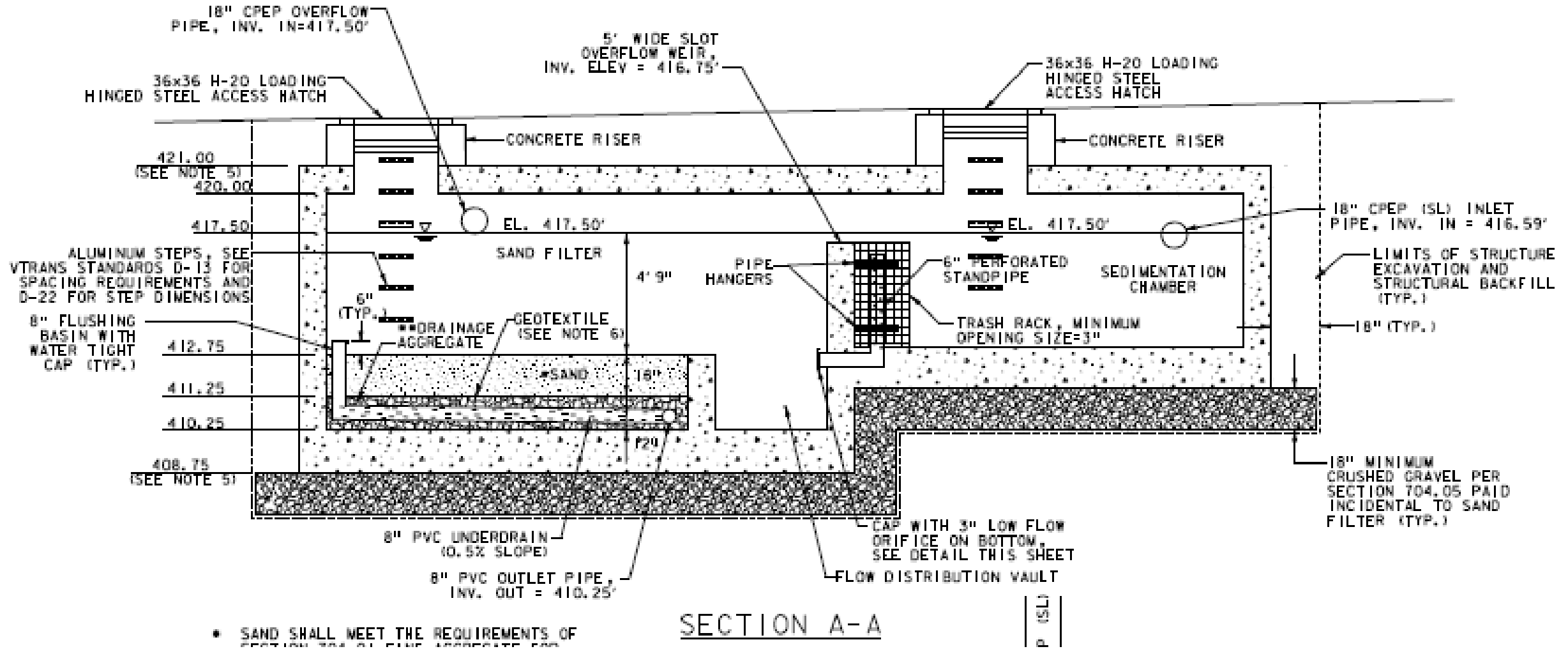



An underground sand filter was installed as part of the operational stormwater permit.

This consists of two chambers that collect the runoff from North Main Street and pass it through the sand filter before it is discharged.



An underground sand filter was installed as part of the operational stormwater permit.

This consists of two chambers that collect the runoff from North Main Street and pass it through the sand filter before it is discharged.

Underground Unknowns





QUESTIONS?